

Type 58 c 80 cm Ringstand. ("Tobruk") Emplacement for machine gun (1) 20

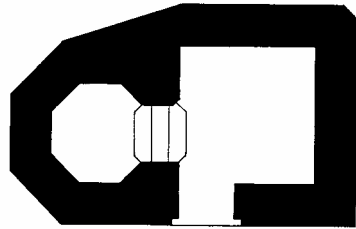

1 : 100

This construction exists in a multitude of versions. With 40 cm and 60 cm thick walls and with a small and a large annex room. Some constructions have a short tunnel leading up to the entrance to prevent it from being obstructed by sliding sand. Additionally all versions can be found mirror imaged.



Type 58 c in RINGELNATTER.

Type ?? "Ringstand ROBBE". Emplacement for machine gun.

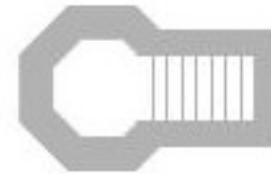
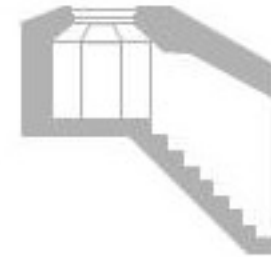

1 : 100

This construction has only been found in ROBBE SÜD.



"Ringstand ROBBE".